

**Description**

PLCM09 is a wireless modem plug in available for the eXware and eX700 series. With 4 LED indicators on module and network status, a microSIM slot and powered via the plug in connection, the PLCM09 adds the ability to communicate with all machines and systems worldwide.

Pin	Description	Pin	Description
1	OUT 1A	5	IN 1+
2	OUT 1B	6	IN 1-
3	OUT 2A	7	IN 2+
4	OUT 2B	8	IN 2-

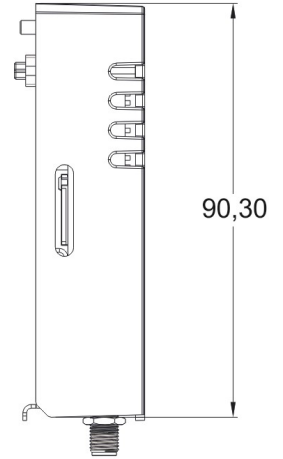
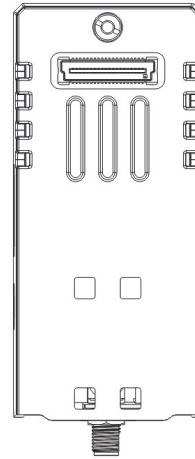
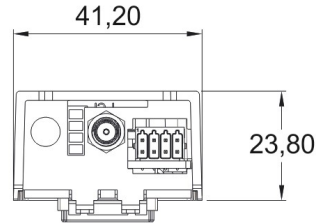
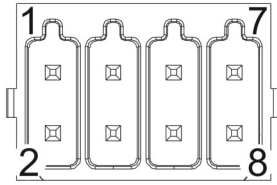

Description	Specifications
Input channels (IN 1 & 2)	2 digital optoisolated (industrial standard) source active high (+24VDC) inputs. Input voltage range 12-30VDC (min 3mA), 35VDC max for 500 ms
Output channels (OUT 1 & 2)	2 digital optoisolated SSR type outputs, 2 contacts each. Max load voltage 30VDC, Max load current 0.5A
Connector type	DFMC 0,5/ 4-ST-2,54-RF Phoenix Contact

The I/O channels are SELV (Safety Extra - Low Voltage) according European Standards

**LEDs description**

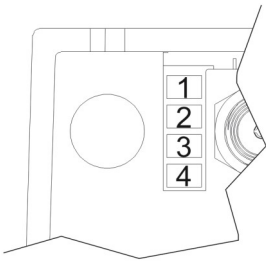

LED	Specifications
1	User configurable
2	User configurable
3	Modem status ON/OFF
4	Netlight (network status indication LED)

1 MANPLCM09-001 V.1.02 09.18

2 MANPLCM09-001 V.1.02 09.18

**Mounting the module**

Remove the connector protective cover from the equipment before installing the module.

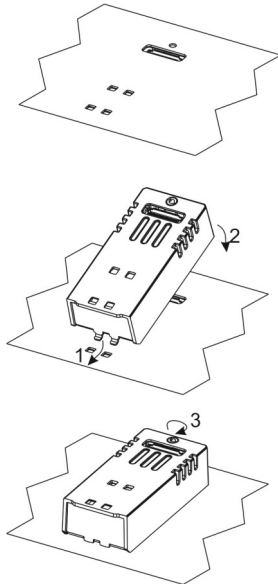

The connection and installation have to be performed by authorized, qualified personnel and in possession of necessary skills

WARNING: Do not separate when energized.

This device cannot be disposed of as a domestic waste but according to WEEE European Directive 2012/19/EU

3 MANPLCM09-001 V.1.02 09.18

The product has been designed for use in industrial, residential, commercial, light industrial and marine environment in compliance with the 2014/53/EU, 2011/65/EC directives on Exor eXware and eX700 series products. The full text of the EU declaration of conformity is available at the following Internet address: [www.exorint.com](http://www.exorint.com)

The products have been designed in compliance with:

- EN 61000-6-4
- EN 61000-6-2
- EN 61000-6-3 \*
- EN 61000-6-1
- EN 60945
- ETSI EN 301 489-1
- ETSI EN 301 489-52
- EN 301 511
- ETSI EN 301 908-1
- ETSI EN 301 908-2
- EN 62311 \*\*
- EN 60950-1

\* The installation of this device on eX700 series into the residential, commercial and light-industrial environments is allowed only in the case that special measures are taken in order to get the conformity to EN 61000-6.3.

\*\* Standard radio signal and minimum distance from the body calculated according to EN 62311

Standard radio signal	Minimum distance from the body (cm)
EGSM900	13,5
DCS1800	9
WCDMA Band I	5,5
WCDMA Band VIII	8
GSM 850/900	24
GSM 1800/1900	12

Reproduction of the contents of this copyrighted document, in whole or part, without written permission of Exor International S.p.A., is prohibited.

MANPLCM09-001  
V.1.02 10.09.2018

4

**Descrizione**

Il PLCM09 è un plug-in modem wireless disponibile per eXware e serie eX700. Con 4 LED per informazioni di stato, uno slot microSIM e alimentato tramite connessione plug-in, il PLCM09 dà la possibilità di comunicare con le macchine e i sistemi in tutto il mondo.

Pin	Descrizione	Pin	Descrizione
1	OUT 1A	5	IN 1+
2	OUT 1B	6	IN 1-
3	OUT 2A	7	IN 2+
4	OUT 2B	8	IN 2-

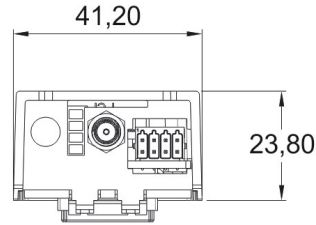
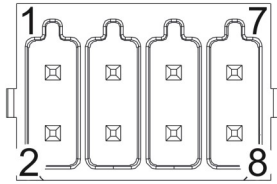

Descrizione	Specifiche
Input (IN 1 & 2)	2 ingressi digitali optoisolate (standard industriale) con ingresso attivo (+24VDC). Range tensione di ingresso 12÷30VDC (min 3mA), 35VDC max per 500 ms
Output (OUT 1 & 2)	2 uscite digitali optoisolate tipo SSR, 2 contatti ciascuna. Tensione massima di carico 30VDC, corrente massima di carico 0.5A
Tipo connettore	DFMC 0,5/ 4-ST-2,54-RF Phoenix Contact



I canali I/O sono SELV (Safety Extra - Low Voltage) secondo le norme europee

**Descrizione dei LED**

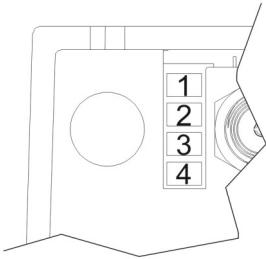

LED	Specifications
1	Configurabile dall'utente
2	Configurabile dall'utente
3	Modem ON/OFF
4	Netlight (LED indicatore stato rete)

1 MANPLCM09-001 V.1.02 09.18

**Montaggio**

Rimuovere dall'apparecchiatura la protezione di copertura del connettore prima di installare il modulo.

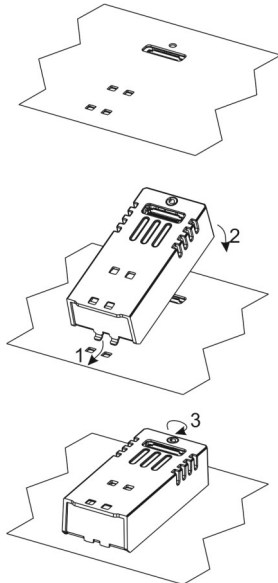

I cablaggi e l'installazione devono essere eseguiti da personale autorizzato, qualificato ed in possesso delle necessarie competenze.



AVVERTIMENTO: Non scollegare sotto tensione.



Questo dispositivo non può essere smaltito come rifiuto domestico in accordo alla Direttiva Europea RAEE 2012/19/UE



3 MANPLCM09-001 V.1.02 09.18

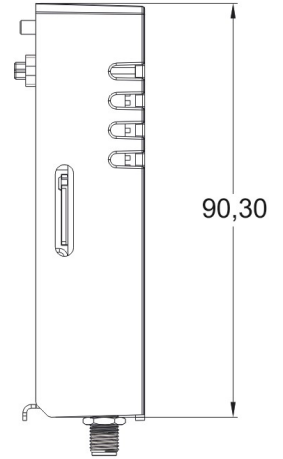
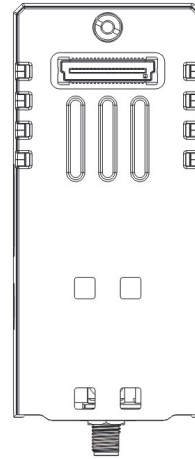

2 MANPLCM09-001 V.1.02 09.18

Il prodotto è stato progettato per l'impiego in ambiente industriale, residenziale, commerciale, dell'industria leggera e marino in conformità alle direttive 2014/53/UE, 2011/65/CE su prodotti Exor serie eXware ed eX700. Il testo completo della dichiarazione di conformità UE è disponibile al seguente indirizzo Internet: [www.exorint.com](http://www.exorint.com)

Il prodotto è stato progettato in conformità alle norme:

- EN 61000-6-4
- EN 61000-6-2
- EN 61000-6-3 \*
- EN 61000-6-1
- EN 60945
- ETSI EN 301 489-1
- ETSI EN 301 489-52
- EN 301 511
- ETSI EN 301 908-1
- ETSI EN 301 908-2
- EN 62311 \*\*
- EN 60950-1

\* L'utilizzo di questa apparecchiatura su serie eX700 in ambienti residenziali, commerciali e dell'industria leggera è permesso solo nel caso in cui vengano prese le misure speciali per ottenere la conformità alla EN 61000-6-3.

\*\* Standard segnale radio e distanza minima dal corpo calcolata secondo EN 62311

Standard segnale radio	Distanza minima dal corpo (cm)
EGSM900	13,5
DCS1800	9
WCDMA Band I	5,5
WCDMA Band VIII	8
GSM 850/900	24
GSM 1800/1900	12

Nessuna parte di questo manuale può essere riprodotta senza il preventivo permesso scritto di Exor International S.p.A.

MANPLCM09-001  
V.1.02 10.09.2018

4